

21 Oakey Close

Longford, Coventry, CV6 6JD

A great opportunity to purchase a first time home, or investment property. Nestled in a cul de sac position, this ground floor maisonette offers two double bedrooms, spacious lounge, bathroom and kitchen with views over and door out to the delightful communal garden area. The property is located in Longford and just a short distance to fabulous amenities including the Arena Park Shopping Park, Longford Park and easy access to major road networks for those that need to commute. The property benefits from PVCu windows and door and is heated via electric units.

£119,999

21 Oakey Close

Longford, Coventry, CV6 6JD



- Great Investment or First Time Buyer Property
- Cul De Sac Location
- Council Tax Band A
- Service Charge & Ground Rent approx £750 per year
- Ground Floor
- Spacious Rooms
- Communal Garden
- Two Double Bedrooms
- EPC RATING E
- 91 Years Remaining Lease (Approx)

Entrance Hallway

Lounge

13'10" x 11'9" (4.22 x 3.6)

Kitchen

10'9" x 8'11" (3.30 x 2.74)

Bedroom One

13'5" x 9'8" (4.11 x 2.97)

Bedroom Two

11'1" x 7'8" (3.38 x 2.34)

Bathroom

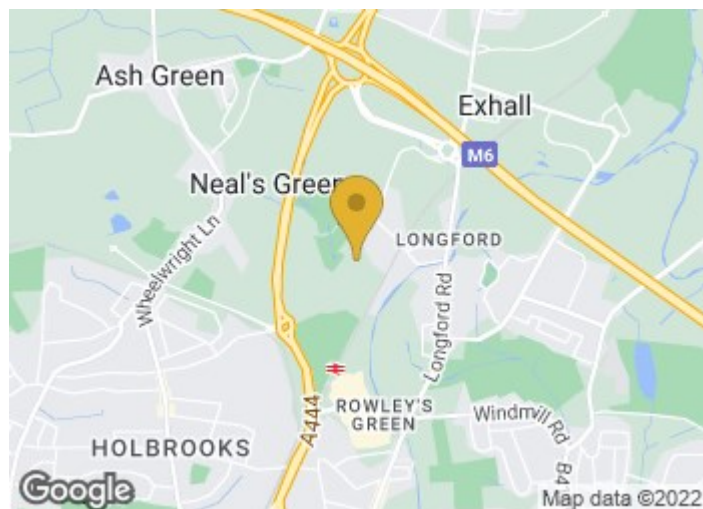

Directions



OKEY CLOSE

Approximate Gross Internal Area 826 sq ft / 76.70 sq m

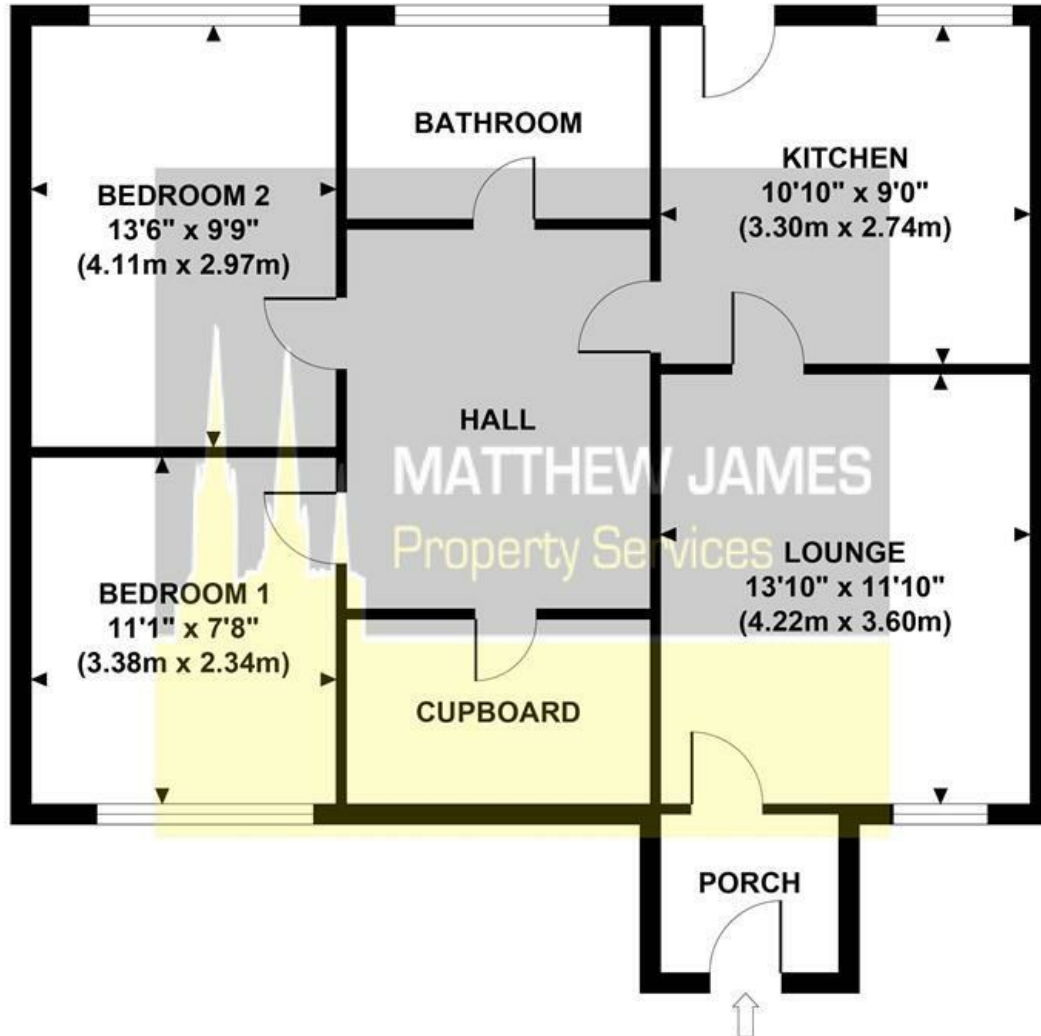

**GROUND FLOOR
GROSS INTERNAL
FLOOR AREA 826 SQ FT**

Although every attempt has been made to ensure accuracy, all measurements are approximate and no responsibility is taken for any error, omission, or mid-statement. This floor plan is for illustrative purposes only and not to scale. Measured in accordance to RICS standards.

These particulars, whilst believed to be accurate are set out as a general outline only for guidance and do not constitute any part of an offer or contract. Intending purchasers should not rely on them as statements of representation of fact, but must satisfy themselves by inspection or otherwise as to their accuracy. No person in this firm's employment has the authority to make or give any representation or warranty in respect of the property.

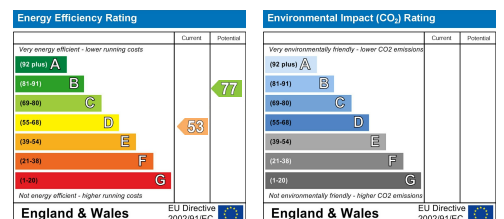

CONTACT INFORMATION

📍 24a Warwick Row, Coventry CV1 1EY

☎ 02477 170170

✉ info@matthewjames.uk.com

🌐 www.matthewjames.uk.com

📘 Facebook

🐦 Twitter